

***Construction Updates:***

For additional construction project information and photos visit the Facilities Management website at <http://www.csufresno.edu/facilitiesmanagement>

***Henry Madden Library:*** On February 19, 2009 at 10:30 the Henry Madden Library will hold its ribbon cutting ceremony. The library will officially open to students February 20!



On February 2, library staff began moving into both the north and south wings of the building. They should complete their move in by February 13.



There are many stunning elements to the library, such as the grand staircase, the ellipse, the curtain wall, and the circulation and lobby area, with its mosaic tile representing one of the basket weave designs of the Table Mountain Rancheria.





***The Peace Garden:*** The Peace Garden construction is almost complete. The garden is now reopened to the public. The new Peace Garden design adds walkways for better accessibility to the garden's statues as well as shaded, grassy knolls to sit upon, new benches and a new grove on the northwest corner in dedication to Dean Richard D. Ford.

The new Dean Richard D. Ford Memorial Grove is a ring of Chinese Pistache trees that will shade a curricular pathway and seating area. This area should be completed by the end of the month.



The renovated Peace Garden is the ideal place for quiet meditation as well as being able to accommodate a group experience.

**University High School:** (Currently on hold due to the budget crisis) California State University, Fresno will construct a one-story, \$15 million, 37,500 GSF facility for the University High School. This project will provide classrooms, science labs, and a computer music room. It will also contain a music center which houses three rehearsal rooms and an administrative center which houses the principal, support staff, faculty, and counseling support personnel. In addition, the project includes a circular drive at Maple Avenue that will allow for greater flow of traffic. The completion of this project will allow the high school to vacate the temporary trailers that currently house the student population of 400 students. The building is sited between the Smittcamp Alumni House and the Joyal Administrative Building, north of Matoian Way.



Schematic design by Arthur Dyson and Associates

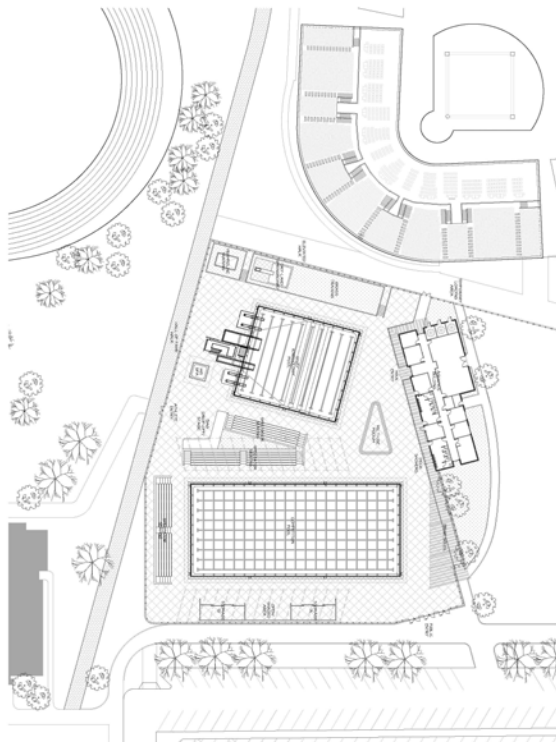

Layout design by Taylor Teter Partnership

**Aquatic Center:** The Aquatic Center is currently in schematic design. It will include replacement of the antiquated pool currently housed in the North Gym and is sited north of the North Gym and east of Bulldog Stadium. This project will accommodate both Academics and Athletics. The project consists of the following components: an eight foot deep competition swimming pool that meets NCAA Division 1A requirements for Long Course and Short Course swimming, with eight lanes provided along a 50 meter long racing course; a dive/kinesiology pool that has a depth which meets the NCAA Division 1A requirements for competition diving and a shallow area for aquatic courses, with accessibility for disabled persons; a warm-up/warm-down pool for up to eight divers and swimmers during competitive and noncompetitive events, maintained with a constant desired temperature; two 1-meter and two 3-meter spring board diving boards designed in accordance with NCAA Division 1A requirements; a dive tower equipped with 5-meter, 7-meter and 10-meter diving platforms and an enclosed stair shaft

designed in accordance with NCAA Division 1A requirements; pool deck areas surrounding the pool shall be designed to accommodate circulation of athletes, spectators, officials and coaches

with site design allowing for segregation of athletes from spectators during heavily attended event days and an integrated deck shower area for swimmers and divers; spectator seating along the south end of the competition pool and dual facing seating at the west end of the competition pool and east end of the diving pool with portions of the seating areas under roof cover and equipped with site lighting. This project is expected to be completed spring 2010.

***Nursing Renovation:*** (Currently on hold due to the budget crisis). The Nursing Renovation in McLane Hall is currently in schematic design. This project consists primarily of retrofitting two classrooms into one large nursing classroom to accommodate 95 FTE.

***Equestrian Center Improvements:*** (Currently on hold due to the budget crisis). The Equestrian Center consists of fencing demolition, earthwork and grading, new 10-stall horse structure and horse exercise area, fencing and gates, asphalt accessible parking area and path, water service, drywell and accessible drinking fountain.

***Bulldog Diamond Improvements:*** The berm is completed. Batting cage work should be complete by early May 2009.



***McKee Fisk First Floor Remodel:*** Improvements for the first floor of McKee Fisk, which houses Information Technology Systems (ITS), is underway. These improvements include abatement, floor coverings, electrical upgrades, painting, window coverings, furniture installation and reconfiguration to better accommodate ITS. Phase I and II are completed. Phase III construction anticipated to begin mid-April 2009.